

## Annex A: List of roads and lanes closed during the event

To facilitate security arrangements for the event, the following roads and lanes will be closed to vehicular traffic on Saturday, 9 June to Thursday, 14 June 2018.

Roads and Lanes Affected	Period of Closure
1. Tomlinson Road (between Cuscaden Road and Tanglin Road)	From 9 June to 14 June 2018 (inclusive of both dates)
2. 2 right lanes of Tanglin Road (between Tanglin Mall Taxi Stand and St Regis Hotel Driveway Entrance)	

## Road / Lane Closure From 9 June 2018 to 14 June 2018

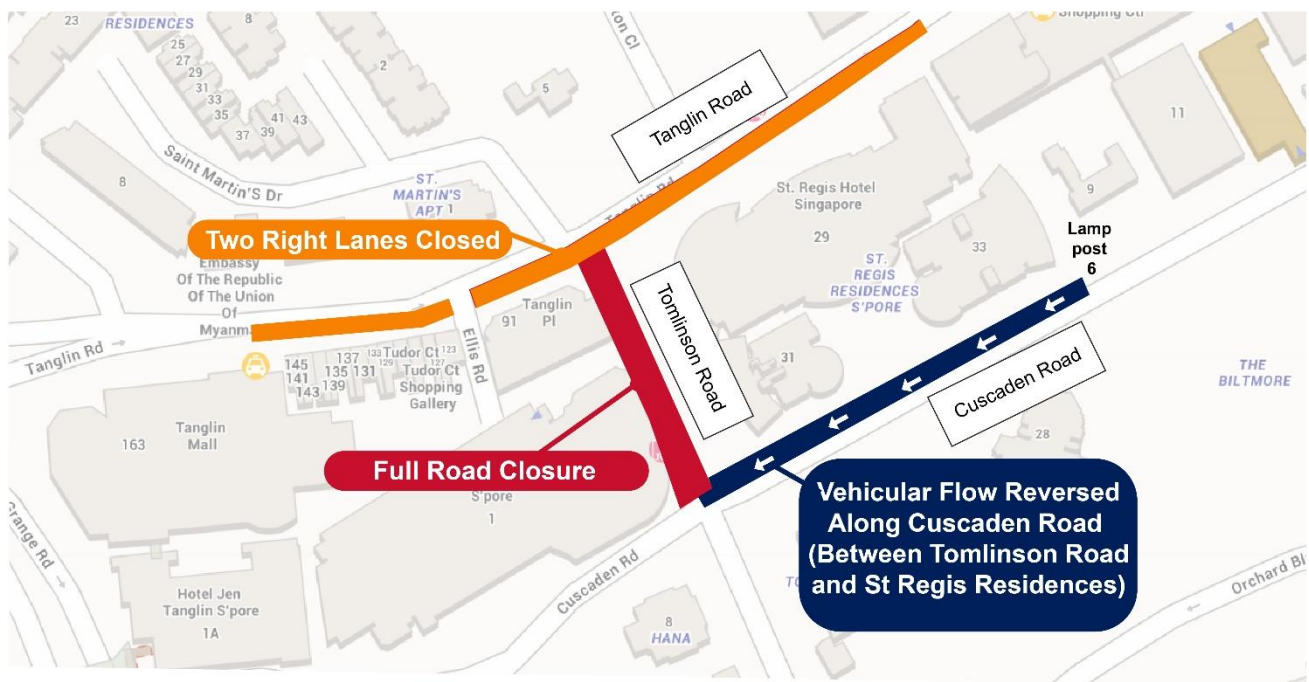

Vehicular traffic along Cuscaden Road in the direction of Orchard Road (between Tomlinson Road and lamp post 6 near St Regis Residences) shall be reversed, on Saturday, 9 June 2018 to Thursday, 14 June 2018. Hence, vehicles can only turn right into Tomlinson Road in the direction of Orchard Boulevard.

# Road Diversion

## From 10 June 2018 to 14 June 2018

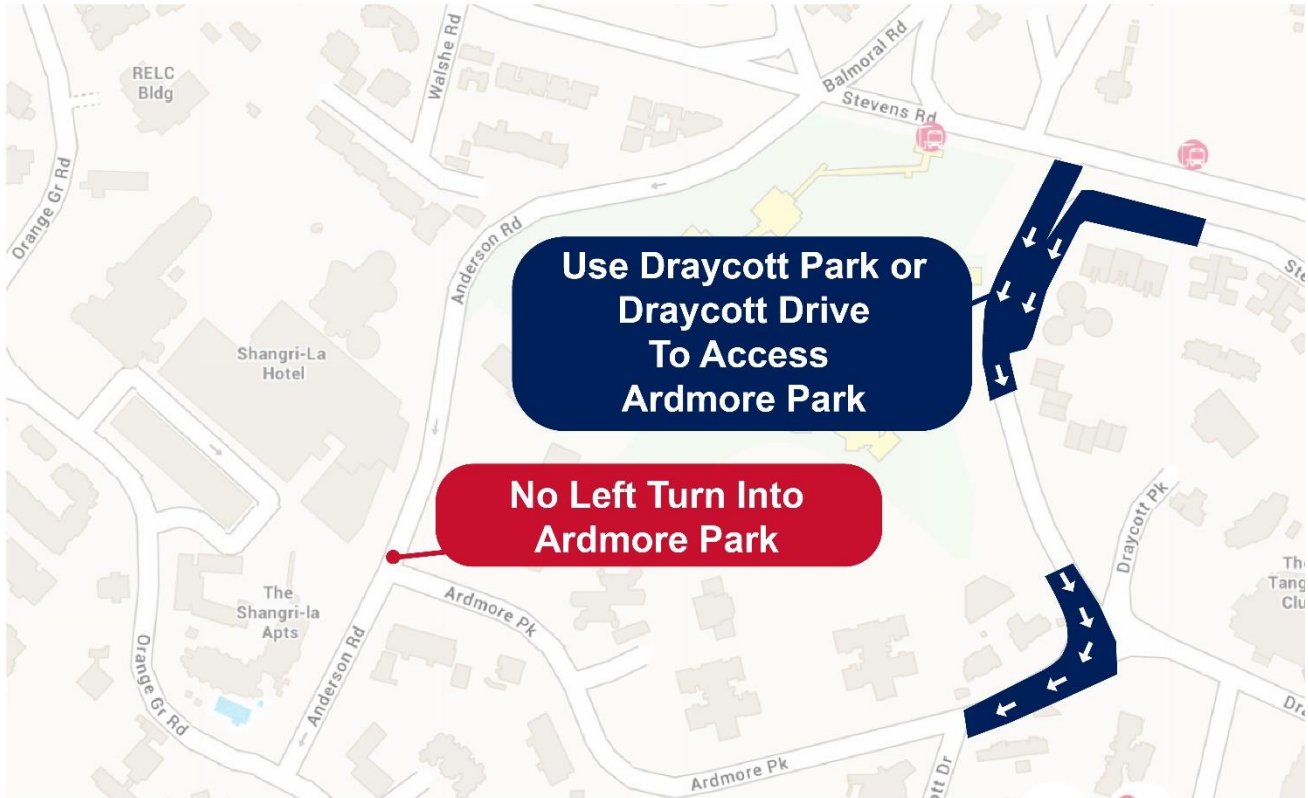

Vehicular traffic along Ardmore Park in the direction of Draycott Drive (between Anderson Road and lamp post 6 near Ardmore II Condominium) shall be reversed, from Sunday, 10 June 2018 to Thursday, 14 June 2018. Hence, vehicles are not allowed to turn into Ardmore Park from Anderson Road. Motorists going to Ardmore Park are advised to use Draycott Park or Draycott Drive instead.